

BluesSystem LV Series



GENERAL INFORMATION

**BlueDome**

BlueDome provides dimmable, omni-directional LED light designed to gently illuminate stairwells, lobbies, wing spaces and seating areas. The optional, snap-on eyelid accessory ensures that your BlueDomes provide safe illumination while conforming to the design needs of your venue.

**APPLICATIONS**

- Onstage running lights
- Auditoriums
- Lobbies
- Houses of worship
- Museums
- Studios

**GENERAL**

- Must be used with BluesSystem Power Supply (see separate datasheet)
- Three-year warranty
- Ambient operating temperature 0–40° C / 32–104° F
- Indoor use only

**OPTICAL**

- Available in frosted or opaque lens options
- Light spill masking accessories available
- Single-color, 3 W blue LED emitter

**ELECTRICAL**

- Low Voltage 11-36 VDC operating range
- 3W LED consumes 85 mA @ 36 V (130 mA @ 24 V)
- Three screw terminal connections on rear (power/ground/control)
- Must be used with BluesSystem power supply only
- Supplied with wiring harness and Wago connector for easy termination

**MECHANICAL**

- Supplied with two mounting screws
- Fits standard 51 mm mounting pattern UK electrical boxes
- Supplied with choice of adapter plate (see options below)
- Durable injection-molded housing

**REGULATORY AND COMPLIANCE**

- cETLus Listed
- Conforms to ANSI/UL 2108
- Certified to CSA STD. C22.2 No. 250.0
- CE Compliant

ORDERING INFORMATION

**BLUEDOME**

BS			
MODEL	BEAM/DOME	COLOR	LENS TYPE
BS- BluesSystem	D- Dome	B- Blue	O- Opaque F- Frosted

**EXAMPLE**

BS	D	B	F
----	---	---	---

BSDBF - BluesSystem BlueDome, Blue, Frosted.



ACCESSORIES

**BSEL - EYELID**



**BSC - COWL**



Both the eyelid and cowl accessories snap easily on to the front of a BlueBeam or BlueDome luminaire via the included accessory ring. The eyelid is designed for use with the BlueDome to shield glare when the luminaire is used at low level. The cowl is typically used on a BlueBeam that has been installed as a downlight, providing perfect light spill protection from on-stage areas.

ADAPTER PLATE OPTIONS

BlueBeam and BlueDome fixtures are supplied with your choice of adapter plate for mounting to standard electrical junction boxes as dictated by regional norms.

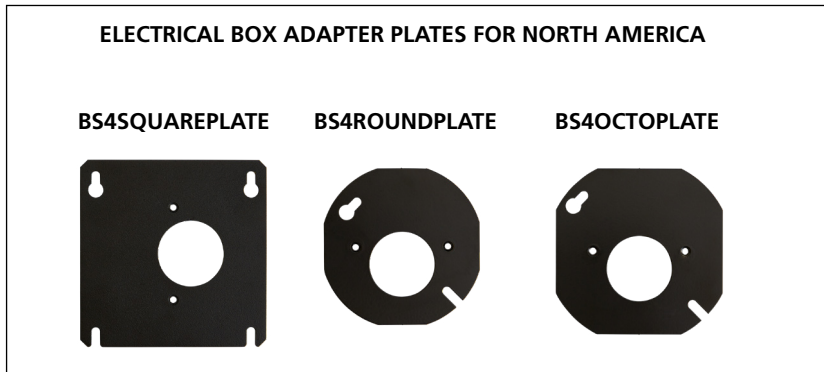

POWER SUPPLY OPTIONS

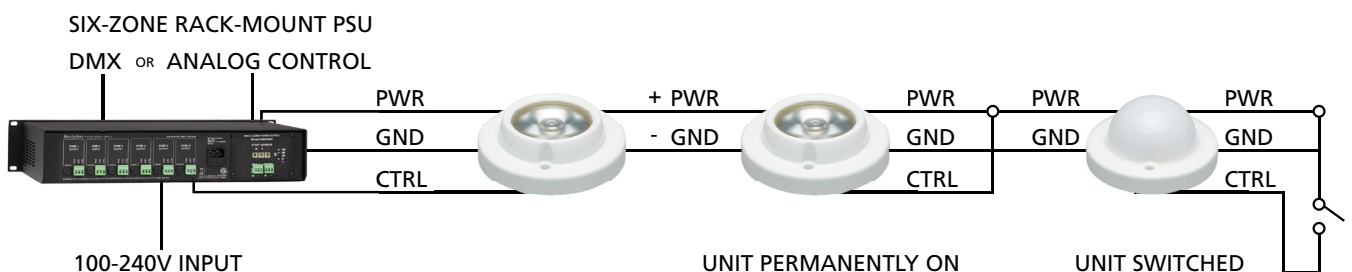

PHOTOMETRICS

BlueDome Opaque

Mode	Candela	Field Lumens	Power Consumption	Efficacy (lpw)
Full Intensity	2.3	2.3	3.8	0.6

Metric conversions: For meters, multiply feet by 0.3048.  
For lux, multiply footcandles by 10.76.

Throw Distance (d)	10 ft 3.0 m	15 ft 4.6 m	20 ft 6.1 m	25.0 ft 7.6 m	
Illuminance (fc)	0.023	0.010	0.006	0.004	1
Illuminance (lux)	0.25	0.11	0.06	0.04	10.76

Candela Plot

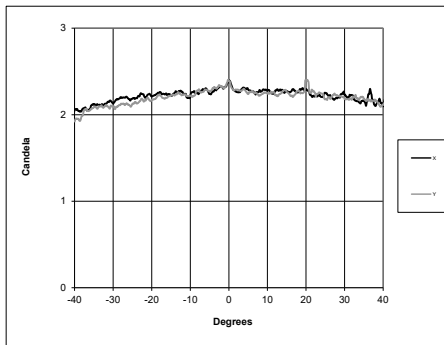

Iso-Illuminance Diagram (Flat Surface Distribution)

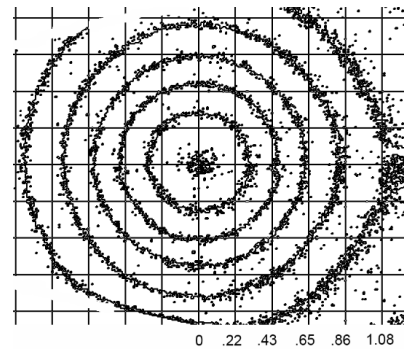

BlueDome Frosted

Mode	Candela	Field Lumens	Power Consumption	Efficacy (lpw)
Full Intensity	5.1	3.2	3.8	0.8

Metric conversions: For meters, multiply feet by 0.3048.  
For lux, multiply footcandles by 10.76.

Throw Distance (d)	10 ft 3.0 m	15 ft 4.6 m	20 ft 6.1 m	25.0 ft 7.6 m	
Illuminance (fc)	0.051	0.023	0.013	0.008	1
Illuminance (lux)	0.55	0.24	0.14	0.09	10.76

Candela Plot

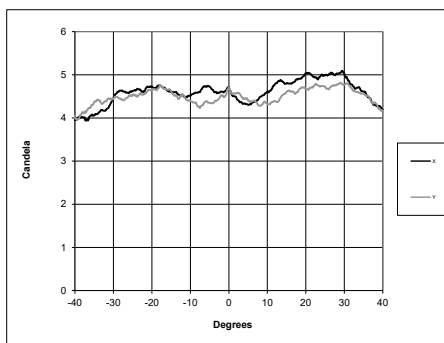

Iso-Illuminance Diagram (Flat Surface Distribution)

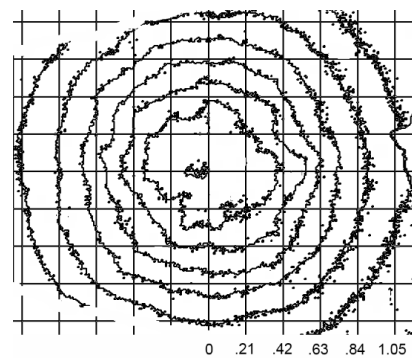

BluesSystem LV Series

PHYSICAL

Product Dimensions

MODEL	HEIGHT		WIDTH		DEPTH	
	in	mm	in	mm	in	mm
BlueDome	2.62	67	2.62	67	1.42	36

Product Weight

MODEL	WEIGHT		SHIPPING WEIGHT	
	lb	kg	lb	kg
BlueDome	0.12	0.055	0.265	0.12

BLUEDOME

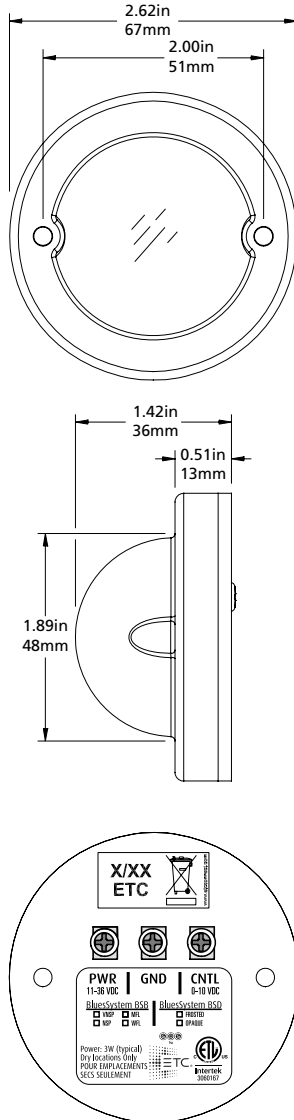

ADAPTER PLATES

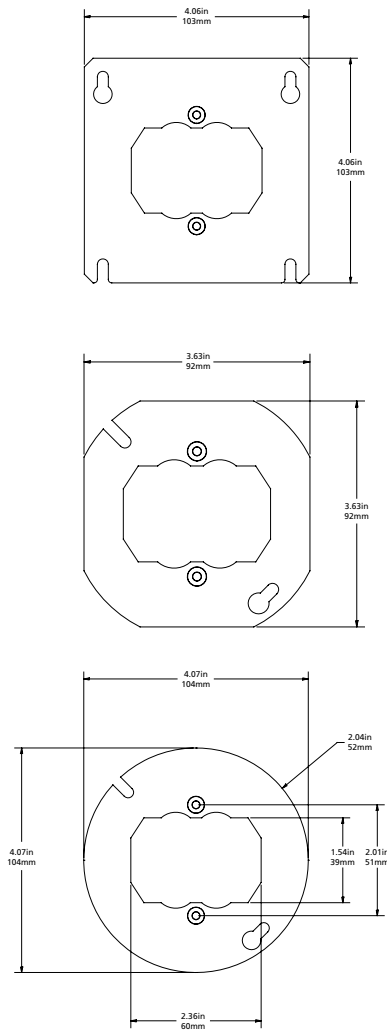

Corporate Headquarters • Middleton, WI USA

Global Offices • London, UK • Rome, IT • Holzkirchen, DE • Paris, FR • Hong Kong • Singapore • New York, NY • Orlando, FL • Burbank, CA

Copyright©2019 ETC. All Rights Reserved. All product information and specifications subject to change. Rev B 08/19

Trademark and patent info: etconnect.com/IP

etconnect.com